

ROOF FRAMING PLAN
1/4"=1'-0" NORTH

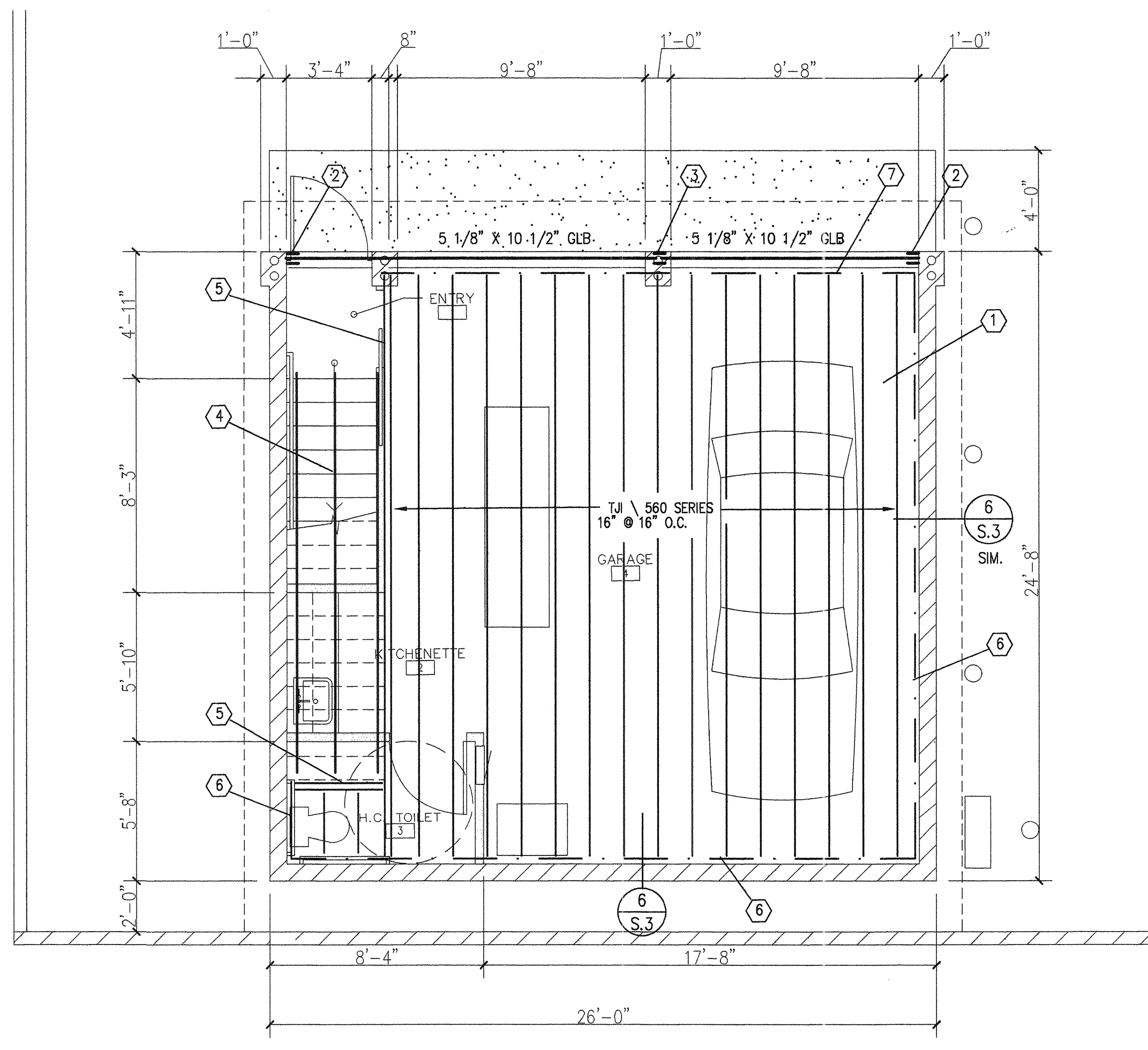

2ND FLOOR FRAMING PLAN
1/4"=1'-0" NORTH

ROOF & FLOOR FRAMING KEYNOTES

1. 1 1/8" TONGUE & GROOVE FLOOR SHEATHING, GLUED AND SCREWED, 6" O.C. EDGES, 12" O.C. FIELD.
2. SIMPSON GLULAM HANGER, MEG5, 7GA STEEL, 2-3/4" DIA. BOLTS THRU GLB, 6-3/4" DIA. ANCHOR J-BOLTS INTO SOLID GROUTED CMU.
3. SIMPSON GLULAM SADDLE CCO, 7GA STEEL, FOR TWO GLULAMS TO MEET AND BUTT TOGETHERS WITH 4-3/4" THRU GLB BOLTS AND 2-#5 REBAR X 12" LONG WELDED TO BOTTOM OF CCO SADDLE AND REBAR EMBED INTO TOP OF CMU COLUMN IN SOLED GROUTED CELLS.
4. WOOD STAIR STRINGERS, 1 3/4"X11 7/8" LVL, ONE EACH SIDE AND ONE IN THE CENTER.
5. DOUBLE UP WOOD JOISTS AT STAIR OPENING.
6. 3X8 WOOD LEDGER WITH 3/4" DIA. A.B.'S @ 16" O.C. PER DETAIL 6/S.3.
7. 2X8 WOOD LEDGER CONNECT TO WOOD STUD WALL ABOVE WITH SIMPSON A34 @ 16" O.C. BEND LEG OVER TO EACH STUD, H2.5 @ 16" O.C. TO EACH STUD AND 3-16D @ EACH STUD.
8. 1/2" O.S.B. SHEATHING WITH PLYCLIPS AT UNBLOCKED JOINTS.

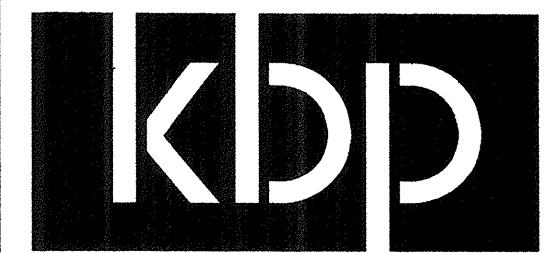

kbp architecture

design ■ planning ■ construction mgmt

11635 E. Tanque Verde Rd.
Tucson, Arizona 85749
Tel 520.749.2340 Fax 520.760.6640
email: kbpctrick@cox.net

Kevin B. Petrick, Architect



EXPIRES 12-31-11
Copyright © 2010 KBP Architecture LLC

Project:

New two story office & garage building

for
Ventana Canyon
Car Wash

4888 N. Sabino Canyon Rd.
Tucson, Arizona

These drawings are project specific and have been developed for the client's use for this project; they may not be reused or duplicated for any other property/project without the written consent of the Architect.

drawing revisions:

--	--

kbp project no: **2328**

date:
AUGUST 19, 2010

sheet title:
1ST & 2ND FRAMING PLANS

sheet number:
S.2

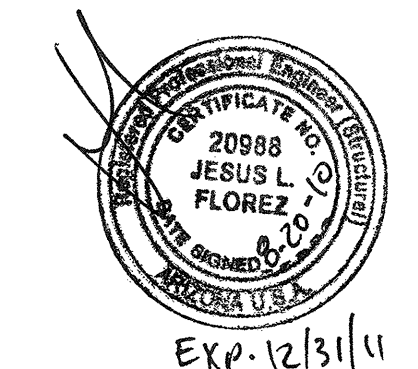

EXPIRES 12/31/11
THESE DRAWINGS WERE PREPARED BY OTHERS AND REVIEWED FOR CONFORMANCE WITH MY STRUCTURAL CALCULATIONS

RESERVED FOR GOVERNMENT APPROVAL STAMPS